

# SARTORIUS

Simplifying Progress



## Cleaning and Maintenance Guide Balances and Moisture Analyzer

2023

# Content

Cleaning and Maintenance for Balances

Cleaning and Maintenance for Moisture Analyzer



# Cleaning and Maintenance for Balances

# Cleaning and Maintenance For Balances | Unlocking

## Open

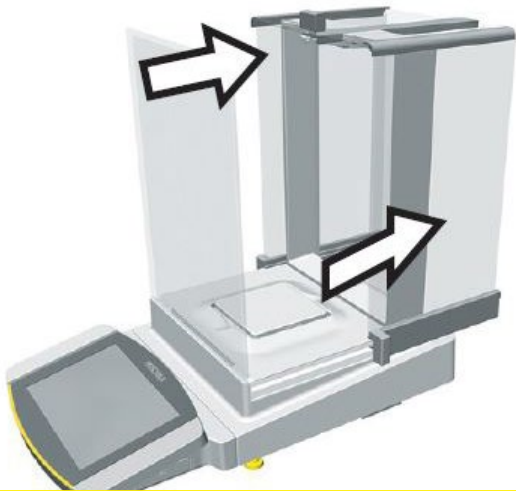

- Disconnect the power supply cable from the wall outlet.
- Fully open the draft shield side panels and upper panel.

## Unlock | Top panel

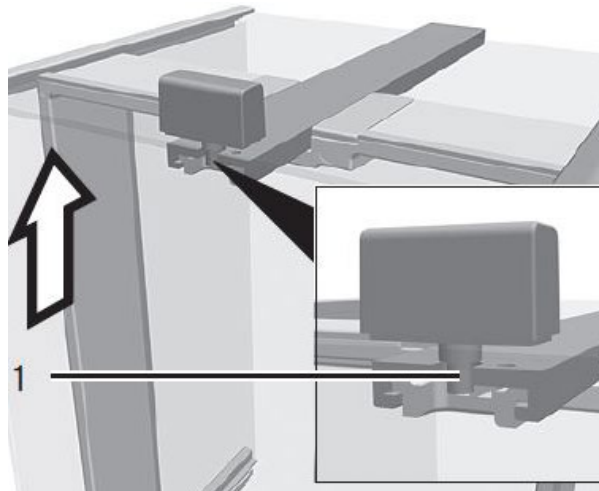

- Press and hold the locking button (1) on the door handle and pull the upper panel completely out of the guide rails.

## Unlock | Side panel

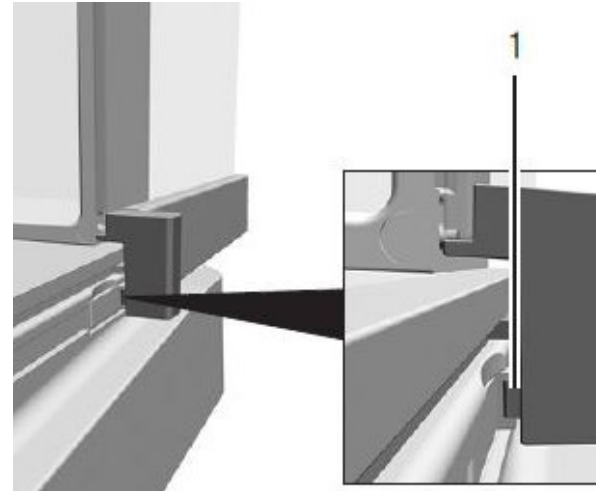

- Press and hold the locking button (1) on the guide rails and pull the side panel completely out of the out the guide rails.

## Unlock | Side panel

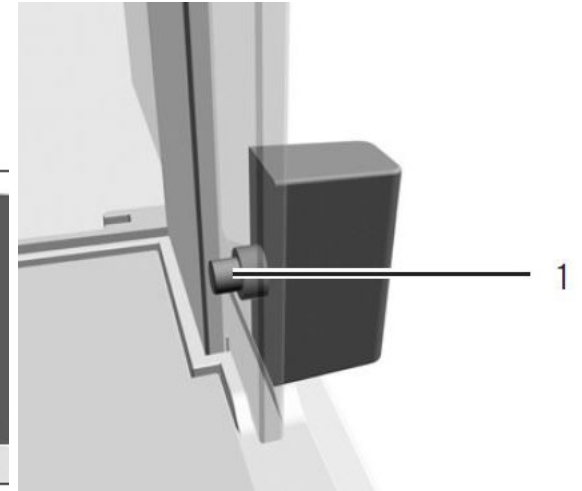

- Press and hold the locking button (1) on the guide rails and pull the side panel completely out of the out the guide rails.

# Cleaning and Maintenance For Balances | Unlocking



- For Analytical Draft Shield or Flat Glass Draft Shield
- Remove the weighing pan and all associated components from the weighing compartment, e.g. shield plate, pan support.

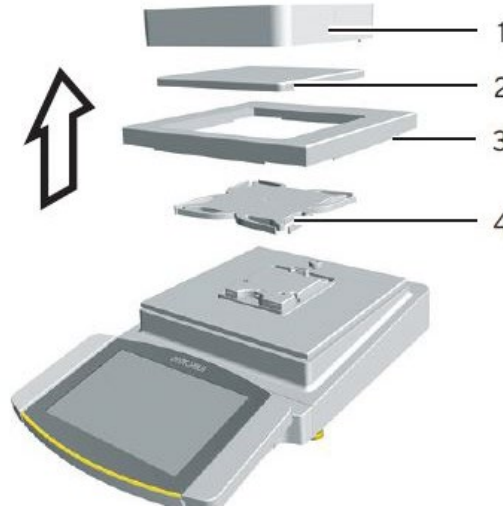

- For Frame Draft Shield
- Remove the weighing pan and all associated components from the weighing compartment, e.g. shield plate, pan support.



- Turn the device off.
- Disconnect the device from the power supply.
- Open the draft shield.

# Cleaning | Cleaning agents

- Do not use corrosive, chloride-containing, or aggressive cleaning agents.
- Do not use cleaning agents that contain abrasive ingredients, e.g. scouring agents, steel wool.
- Do not use solvent-based cleaning agents.
- Check whether the cleaning agents used are compliant materials
- Make sure that cleaning materials, such as cloths, are only slightly damp.



# Recommended Cleaning Agent



- Invisible Glass 91164-2PK 19
- Microfiber towels

[Buy from Amazon](#)

[Buy from Lazada](#)



# Cleaning

- Remove dust and powdery sample residue with a brush or hand-held vacuum cleaner.
- Wipe down the balance base, the shield plate, and the weighing pan with a cleaning agent and a cloth.
- The cleaning agent must be suitable for stainless steel and titanium.
- Wipe the associated components of the weighing pan with a brush or a damp cleaning cloth, e.g. shield plate, support pan.





# Cleaning

- Wipe the device housing with a damp cloth. For more severe contamination, use a mild soap solution.
- If this relates to a device with an analytical draft shield or flat glass draft shield: Wipe the weighing chamber with a damp cloth. For more severe contamination, use a mild soap solution.



# Cleaning

## Tips

- We recommend cleaning the weighing pan on a regular basis, e.g. weekly. Do not allow deposits to form on the weighing pan.
- Protective oil may be applied to the weighing pan for additional protection. The protective oil must be suitable for stainless steel and titanium.



# Cleaning and Maintenance for Moisture Analyzer

# Cleaning | Heating Module

Open

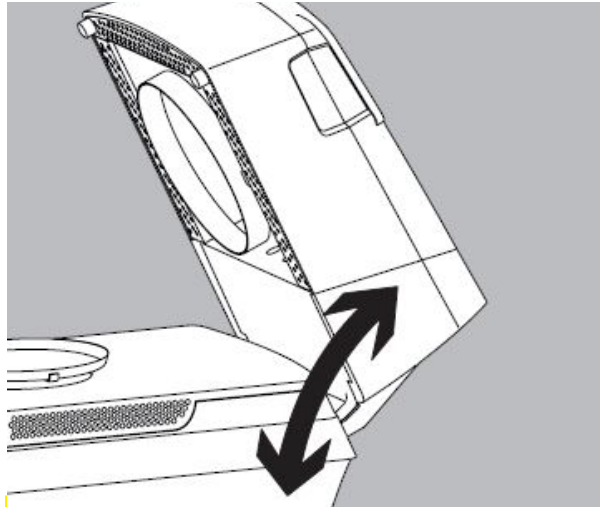

- Open the heating module all the way

Pull

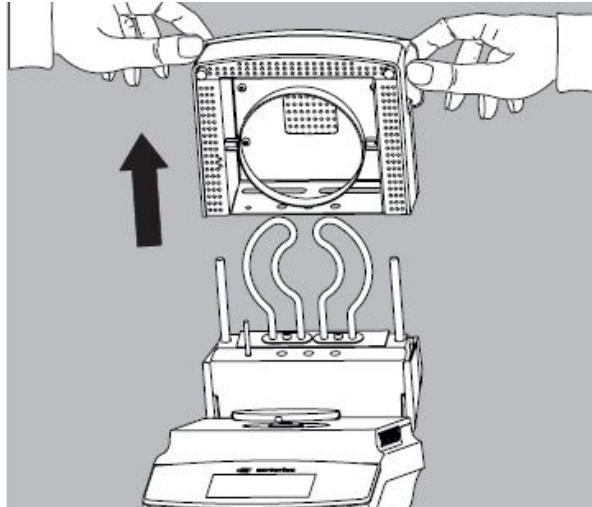

- Pull the heating module back up out of the guide.

Clean

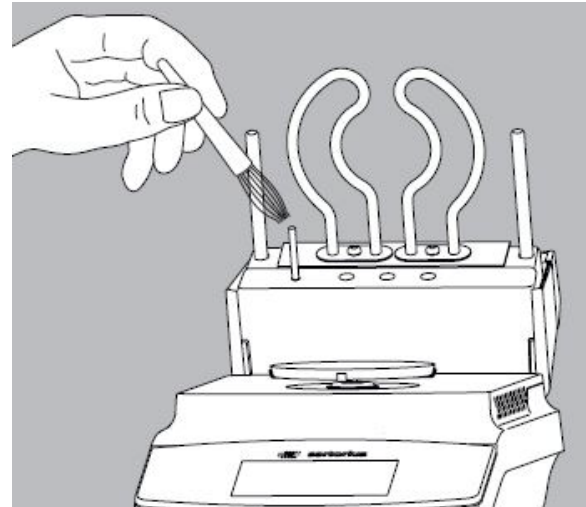

- Clean the heating element and temperature sensor with a weak solvent such as ethanol.

Clean | Done

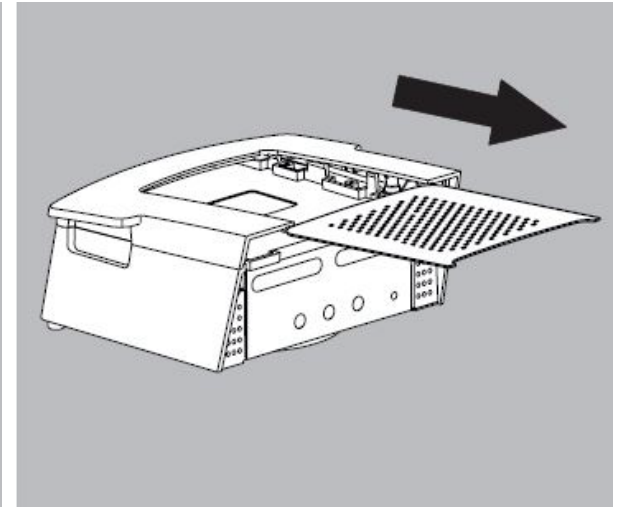

- If necessary, pull the air extractor grate out of the heating module. Then clean the heating module and grate in a dishwasher.

# Cleaning | Sample Chamber Base Plate

Unlock

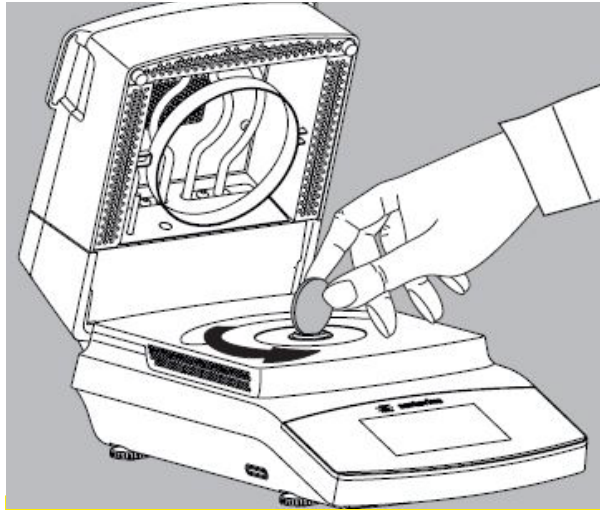

- Unlock the cover socket with a suitable coin.

Clean | Done

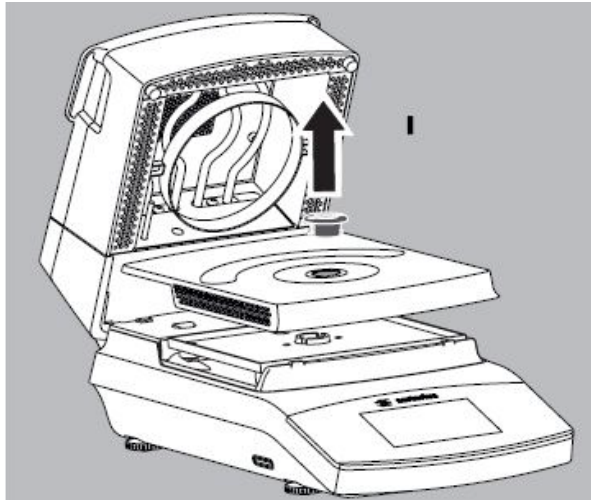

- Remove the cover socket and sample chamber base plate from the analyzer and clean in a dishwasher.

# Thank you.

**Dylan Chan**

Product Specialist, Laboratory Weighing, Southeast Asia

Phone +603 8996 0622

Mobile +601 9221 2475

[dylan.chan@sartorius.com](mailto:dylan.chan@sartorius.com)

The Sartorius logo is displayed in a bold, black, sans-serif font. The letters are closely spaced, and the 'S' and 'A' are particularly prominent. The logo is set against a bright yellow rectangular background.